

KEYBOARD

Stands & Accessories

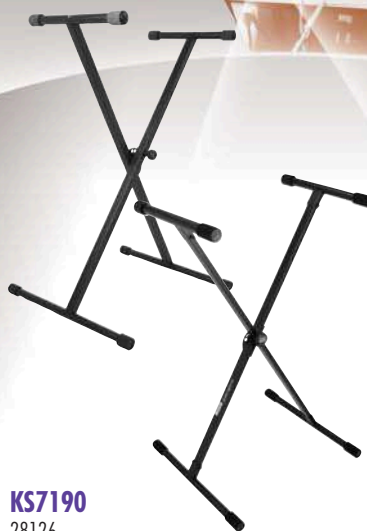

KS7190
28126

Classic Single-X Keyboard Stand

Many of today's musicians like things simple and affordable. That's why we continue to offer this popular Single-X with its classic bullet-nose pull knob and upgraded, stronger 1" square tubing.

Applications: Small-format keyboards
Tubing: 1"
Weight Capacity: 90 lbs.
Height Adj.: 27-38"
Base Spread: 11-31"
Construction: Bolted, Assembly Required

KS8190 **LT**
29979

Lok-Tight Classic Single-X

Same as KS7190, with Lok-Tight construction.

Applications: Small-format keyboards
Tubing: 15 x 30mm
Weight Capacity: 100 lbs.
Height Adj.: 27-38"
Base Spread: 11-31"
Construction: Lok-Tight



KS7191
28613

Classic Double-X Keyboard Stand

This stand uses the same tried-and-true bullet-nose knob as the Classic Single-X, but the all-welded Double-X workhorse adds stability and holds more weight.

Applications: Medium-format keyboards
Tubing: 18mm
Weight Capacity: 200 lbs.
Height Adj.: 27-39"
Base Spread: 11-31"
Construction: All-welded

KS8191 **LT**
29980

Lok-Tight Classic Double-X

Same as KS7191, with Lok-Tight construction.

Applications: Medium-format keyboards
Tubing: 18mm
Weight Capacity: 200 lbs.
Height Adj.: 27-39"
Base Spread: 11-31"
Construction: Lok-Tight

Classic Series Other Features:

1. Classic bullet-nose pull knob and 5-position disk make for simple width and height adjustments.
2. Adjustable rubber arm sleeves can be positioned to fit virtually any keyboard depth.

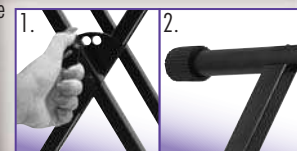

CLASSIC SERIES



LT Lok-Tight Construction

All stands in the KS8000 Series feature Lok-Tight construction, which means that they have the strength of welded construction but also feature the patent-pending bolt system.

A metal sleeve is welded to every Lok-Tight member. This sleeve locks onto the stand which gives Lok-Tight its strength! And, because they lock together, these keyboard stands come unassembled in considerably smaller boxes than welded stands so the cost and storage savings are yours!

KS7290
73210

Pro Single-X ERGO-LOK™ System

Our top-of-the-line Single-X is designed with strength and comfort in mind. This pro-level model features the heaviest tubing we have in our arsenal and is built with an ergonomic trigger, internal rod mechanism, and solid-steel spring-loaded deadbolt.

Applications: Large-format keyboards
Tubing: 30mm
Weight Capacity: 275 lbs.
Height Adj.: 27-38"
Base Spread: 12-32"

KS7291
73200

Pro Heavy-Duty Double-X ERGO-LOK™ System

The high-end Double-X is built for the most demanding of musicians. The ERGO-LOK™ technology, same hefty tubing as the KS7290, and double-X frame make this rugged stand a force to be reckoned with.

Applications: Large-format keyboards
Tubing: 30mm
Weight Capacity: 320 lbs.
Height Adj.: 27-38"
Base Spread: 12-32"

KS7390
73011

quikSQUEEZE™ System Single-X

The quikSQUEEZE™ exemplifies innovation. Adjusting the keyboard is easy as a squeeze, and the steel reinforced clutch holds more weight while keeping your keyboard safe.

Applications: Medium-format keyboards
Tubing: 15 x 30mm
Weight Capacity: 120 lbs.
Height Adj.: 27-39"
Base Spread: 11-30"

KS8290 **LT**
29983

Lok-Tight Pro Single-X ERGO-LOK™ System

Same as KS7290, with Lok-Tight construction.

Applications: Large-format keyboards
Tubing: 30mm
Weight Capacity: 275 lbs.
Height Adj.: 27-38"
Base Spread: 12-32"

KS8291 **LT**
29984

Lok-Tight Pro Double-X ERGO-LOK™ System

Same as KS7291, with Lok-Tight construction.

Applications: Large-format keyboards
Tubing: 30mm
Weight Capacity: 320 lbs.
Height Adj.: 27-38"
Base Spread: 12-32"

KS8390 **LT**
29981

Lok-Tight quikSQUEEZE™ System Single-X

Same as KS7390, with Lok-Tight construction.

Applications: Medium-format keyboards
Tubing: 15 x 30mm
Weight Capacity: 120 lbs.
Height Adj.: 27-39"
Base Spread: 11-30"

KS8391 **LT**
29989

Lok-Tight quikSQUEEZE™ System Double-X

Capable of securely supporting up to 200 lbs. and easily adjustable thanks to the no-fuss, patented quikSQUEEZE™ adjustment system. This stand makes setup and performance a breeze.

Applications: Medium-format keyboards
Tubing: 18mm
Weight Capacity: 200 lbs.
Height Adj.: 27-39"
Base Spread: 11"-30"
Construction: Lok-Tight

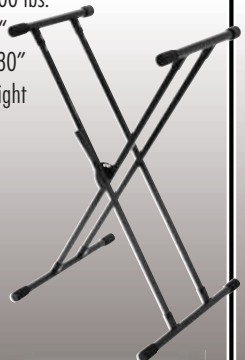

ERGO-LOK™ Other Features:

1. The patented ERGO-LOK™ Technology utilizes an ergonomic trigger, an internal rod mechanism and a solid-steel spring-loaded deadbolt assembly.
2. Simply squeeze the ergonomic trigger to disengage the clutch, position the stand at any of its five convenient height adjustments, and release the trigger to reengage the clutch.



quikSQUEEZE™ Other Features:

Patented quikSQUEEZE™ technology features a 5-position adjustment disk, steel-reinforced clutch, and steel center hinge.





KS7491
40504

Pro Heavy-Duty Double-X with 2nd Tier

The new top-of-the-line double-X with 2nd Tier from On-Stage Stands is ideal for professional musicians! This pro-level model features heavy-duty 30mm square tubing for the frame and support arms/feet. Features an ergonomic top trigger, internal rod mechanism, as well as a solid-steel spring-loaded deadbolt. The included 2nd tier is height and angle adjustable with easy-to-use line-it-up positions.

Applications: Large-format keyboards (88-key)
Tubing: 30mm
Weight Capacity: 320 lbs.
Weight Capacity, 2nd Tier: 75 lbs.
Height Adj.: 26.5-39.5"
Height Adj., 2nd Tier: 4-12" (above 1st tier)
Base Spread: 13-33"
Construction: All-welded



KS7150
35856

Platform Style Keyboard Stand

An extremely strong stand! This fully adjustable model is a great choice for musicians who need support for large keyboards, heavy vintage electric pianos or DJ gear. The KSA7500 Universal 2nd Tier unit can be attached, making this a 2-tier stand!

Applications: DJ, Mixer and Keyboards
Weight Capacity: 230 lbs.
Height Adj.: 26-43"
Width Adj.: 29-43.5"
Depth: 12.5"
Folded Dimensions:
 (w)12.625 x (l)29 x (d)3.5"
Construction: Welded and bolted



The first platform keyboard stand that folds flat! Folding legs are ideal for storage and travel.

Other Features for KS7150:

Telescoping platform adds versatility and adjusts from 29-43.5".



KS7365-EJ
29886

Pro Heavy-Duty Folding-Z with 2nd Tier

Truly professional. Truly heavy-duty. This stand allows for independent height and width adjustments and can hold 2 keyboards, yet folds into a space smaller than most keyboard cases. It was created with the help of some of the most discriminating keyboard professionals in the world, and now any musician can get onstage with this impressive stand!

Applications: DJ, Mixer and Keyboards
Independent Height & Width Adjustments:

- Stand Height Adj.: 28-36"
- Stand Width Adj.: 21-37"
- First Tier Depth: 16.5"

2nd Tier Adjustment Features:

- Height Adj.: 5"-12" (above first tier)
- 2nd Tier Angle Adj.: 10° increments
- 2nd Tier Depth: 16.25"

Construction: All-welded

- Structural Tubing: 1" x 2"
- Center Box Tubing: 3/4"
- Weight Capacity: 400 lbs.
- Weight Capacity, 2nd Tier: 60 lbs.
- Padding: Black Velveteen Rubber

Other Features for KS7365-EJ:

1. Height positions with line-it-up adjustment marks.
2. Arms and feet swing into place or fold for storage.

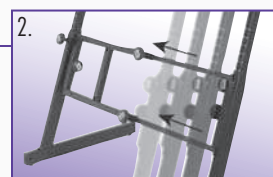

1. Second Tier is removable. Features tilting angle adjustment and independent height adjustments.

2. Box beam allows for easy width adjustments and at the same time adds the stability needed to support up to 400 lbs.



Carry-all-design . . . stand base breaks down into three lockable sections.

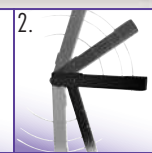



KS7350
28856

Pro Heavy-Duty Folding-Z

Think VERSATILITY! Only this compact stand can hold 375 lbs., allow for independent height and width adjustments, and fold for easy storage. The unique Z-frame allows playing from either side and can be broken down and locked together for transport. This model can hold 55-key keyboards in the compact position and up to 88-key keyboards at its maximum width.

Applications: DJ, Mixer and Keyboards
Structural Tubing: 1 x 2"
Center Box Tubing: 3/4"
Weight Capacity: 375 lbs.
Height Adj.: 24-38"
Telescoping Width Adj.: 21-36"
Construction: All-welded

KSA7550
42000

Professional 2nd Tier

With its internal-locking mounting attachment, the KSA7550 converts your Folding-Z into a 2-tier stand. This height adjustable, tilting tier also adjusts its width along with the stand's. *For use only with the KS7350 Folding-Z Stand.*

Applications: Multiple keyboards
Weight Capacity: 60 lbs.
Height Adj.: 9-14"
Angle Adj.: Up to 30°

KSA7500
34047

Universal 2nd Tier

With its universal mounting attachment, this tilting tier should be everyone's first choice for adding multiple keyboards to most hollow frame keyboard stands. This universal unit can be stacked on top of a 2-tier stand... making it a 3-tier stand! KSA100 End Caps now included.

Applications: Multiple keyboards
Weight Capacity: 60 lbs.
Mounting: 1" or 30mm round or square tubing

KSA7575
35194

Universal Keyboard Mic Attachment Bar

Insert this mounting attachment bar into any keyboard stand with 1" or 30mm round or square tubing. Then, attach any boom, clip or microphone and you are ready to mic your keyboard vocals! KSA100 End Cap now included.

Applications: Keyboards vocals
Weight Capacity: 10 lb. Load
Mounting: 1" or 30mm round or square tubing



KSA8000
53972

Deluxe Universal 2nd Tier

An On-Stage Stands original! This versatile 2nd Tier can fit virtually any keyboard stand with a universal mounting attachment, fitting 1" and 30mm round or square tubing. Two set of 14" support arms feature independent width adjustments to accommodate keyboards, laptops and/or other DJ equipment. The Posi-Lok™ design adjusts and locks the support arms in 10° increments, while the telescoping stabilizer bar adjusts with the width of any stand up to 31". Includes KSA100 End Caps.

Applications: Multiple keyboards; Mounting laptops and/or other small DJ equipment.
Weight Capacity: 65 lbs.
Support Arm Length: 14"
Height Adj.: Notches at 12", 13.5" and 15"
Width Adj.: 17.5-31"
Mounting: 1" or 30mm round or square tubing



The Posi-Lok™ design adjusts and locks the angle of the 2nd tier in 10° increments.

Square clamp design allows for three different positions:

1. Closest to the player
2. Raised to maximum height
3. Farthest from the player



KSA100
54445

Keyboard Stand "Cork-Style" End Caps

These rubber "cork-style" end caps make converting your keyboard stand between single and double tiers easy! They plug into round or square tubular support arms on all brands of X-style keyboard stands. A great complement to the KSA7500, KSA7550 and KSA8000 2nd Tier Units, and KSA7575 Adapter. They also make an ideal replacement for broken or misplaced end caps. Come complete with attached lanyard.

Mounting: 1" or 30mm round or square tubing
Construction: Durable, flexible rubber; Nylon cord



KS7902
29784

A-Frame Keyboard Stand

This versatile A-frame keyboard stand lets you adjust the height and angle of your keyboards until they are just right for playing, whether you are standing or sitting. This lightweight, easy to carry, 48" wide stand is an outstanding value for anyone with a multi-keyboard setup.

KS7903
29785

3-Tier A-Frame Keyboard Stand

Same design as the KS7902, but adds a 3rd tier for even more keyboards and versatility.

KS7902 / KS7903

KS7902 Applications: Dual Keyboards
KS7903 Applications: Multiple Keyboards
Weight Capacity: 88 lbs. per tier
Height Adj.: 54"
Construction: Bolted

Other Features for A-Frames:

1. Support bars slide and rotate. Also allows for two fixed sliding front and back positions.
2. Hinged legs allow stand to fold for easy storage and portability, and the double-lock feature adds support and security.



KB8902B
54787

Flip-Top Bench

This Flip-Top Keyboard Bench is constructed from durable, quality wood. The design combines a 1.5" cushion, which provides extra comfort for hours of play, with a flip-top seat, which provides storage space for music books and other accessories.

KB8802R
55522

Rosewood Keyboard & Piano Bench

This new Rosewood Keyboard Bench features durable, quality wood construction and a beautiful Rosewood finish. The design combines a 1.5" cushion with strategic air vents, which provide extra comfort for hours of play. The KB8802R is an excellent choice for solid support and classic style.

KB8902B

Weight Capacity: 240 lbs.
Height: 19.5"
Cushion Thickness: 1.5"
Bench Seat Size: 13.5 x 22.5"
Materials: Wood and Vinyl
Color: Black



KB8802R

Weight Capacity: 240 lbs.
Height: 19.5"
Cushion Thickness: 1.5"
Bench Seat Size: 13.5 x 22.5"
Materials: Wood and Vinyl
Color: Rosewood

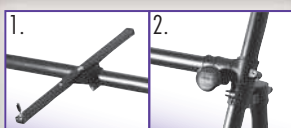

KT7800
55439

Three-Position X-Style Bench

This Three-Position X-Style bench is affordable and perfect for fold-and-go use. Its all-purpose appeal makes it a no-brainer for those looking to buy a basic bench for gigs, the studio or home.

KT7800+
55438

Deluxe X-Style Bench

Our top-of-the line keyboard bench has no equal! The design combines a 3" cushion, providing extra comfort for hours of play, with a spring-loaded double deadbolt locking system, providing extra safety for peace-of-mind.

KT7800

Weight Capacity: 300 lbs.
Height Adj.: 18.75-20.5"
Bench Seat Size: 12 x 17"
Construction: All-welded
KT7800+

Weight Capacity: 360 lbs.
Height Adj.: 19.5-24.5"
Bench Seat Size: 12.5 x 23.5"
Construction: All-welded

Other Features:

1. Legs fold flat for storage and travel.
2. Foam cushion meets all state regulations and is 100% compliant.





KSB-6500

35539

Keyboard Stand Bag

A must for every roadie, this rugged heavy-duty bag is made with padded nylon and includes two hand straps for a well-balanced load. Two internal velcro straps hold support bars and other frame components. Also comes with a two-pull zipper, so the bag can be unzipped length-wise from the center. Deluxe corded piping gives the bag its rigid shape. Holds any of the following models: KS7350, KS7365-EJ, KS7150.

Dimensions: (l)30 x (w)16 x (d)8.75"

Color: Black



KDA7061B

40976

61/76-Key Keyboard Dust Cover, Black

Keep your keys free of harmful dust and debris with this dust cover. Dust free spandex material stretches to fit 61/76-key keyboards. Comes complete with a built-in bag, plastic cord and locking clasp.

KDA7088B

40978

88-Key Keyboard Dust Cover, Black

Same design as KDA7061B, but stretches to fit 88-key keyboards.

KDA7061B / KDA7088B

KDA7061B Size: 61/76-key keyboards

KDA7088B Size: 88-key keyboards

Material: Spandex

Color: Black

[PACK] →



KDA7061G

40977

61/76-Key Keyboard Dust Cover, Gray

Keep your keys free of harmful dust and debris with this dust cover. Dust free spandex material stretches to fit 61/76/key keyboards. Comes complete with a built-in bag, plastic cord and locking clasp.

KDA7088G

40979

88-Key Keyboard Dust Cover, Gray

Same design as KDA7061G, but stretches to fit 88-key keyboards.

KDA7061B / KDA7088B

KDA7061G Size: 61/76-key keyboards

KDA7088G Size: 88-key keyboards

Material: Spandex

Color: Gray

[PACK] →



KSP100

42808

Keyboard Sustain Pedal

A full size piano-style pedal that is perfect when you need a sturdy and responsive control over sustain! This high-quality pedal features a polarity switch making it compatible with virtually any keyboard. The heavy-duty spring allows for better control and durability. Compatible with any electronic keyboard with a 1/4" sustain jack, including Yamaha, Casio, Korg, Roland and MORE!

← [PACK]



KSP20

52316

Keyboard Sustain Pedal

A versatile universal sustain pedal with a built-in 6' cord and polarity switch. The KSP20 is compatible with any electronic keyboard with 1/4" sustain jack. The rugged design features a built-in tread on top and four rubber feet on the bottom.

